

VISOR ASSEMBLY

REF: E012-1 01-06-00

INSTALLATION INSTRUCTIONS

ASSEMBLY:

The visor is supplied with a foam sealing strip, fixing screws and a hexagon drive key.

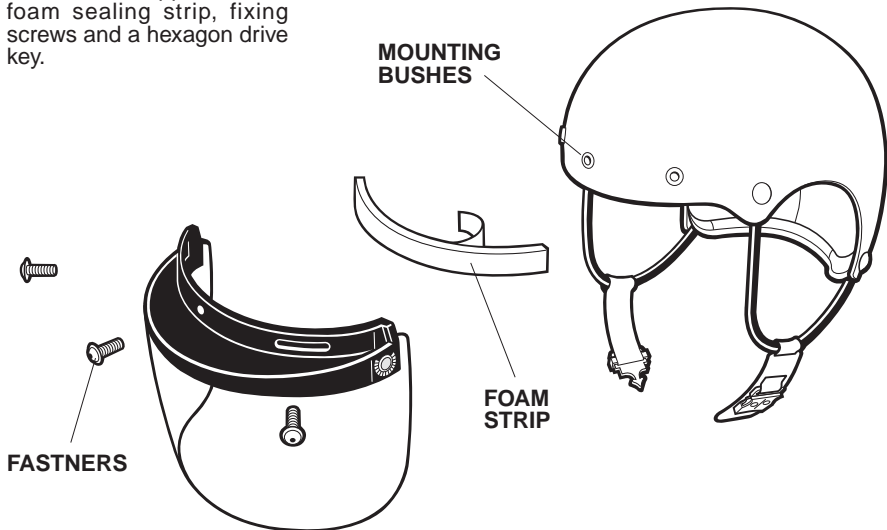

1. Remove the backing from the self-adhesive sealing strip and apply the strip to the helmet in such a way as to cover the three visor mounting bushes.
2. Once in place, make a hole through the strip into each bush in order to help locate the fixing screws.
3. Position the visor in relation to the bushes taking care not to cross-thread the screws.
4. Fasten the visor securely in place.

IMPORTANT

READ THIS INFORMATION CAREFULLY BEFORE
ATTEMPTING TO USE THIS ITEM OF EQUIPMENT