

IN-LINE HEADSET BATTERY

REF: E099-0 01-07-13

INSTALLATION INSTRUCTIONS

The In-line Headset Battery provides an additional portable power source for Micro System headsets.

Micro System headsets have a rechargeable battery in the headset headband. The headset battery allows the headset to work as an autonomous intercom and provides power to portable radio interface equipment and other Micro System accessories.

The In-line Battery is designed to connect between a Micro System headset and any other item of Micro System equipment and can be used to provide the following functions:

1. The In-line Battery can be used as a back-up battery when the internal headset battery is discharged.
2. The In-line Battery can be used as an alternative power source when the internal headset battery is disabled.
3. The In-line Battery can be used to extend the life of older headsets as an alternative to replacing the headset batteries.

NOTE:

Whilst the In-line Battery is connected to a Micro System Headset, the internal headset battery is disabled.

The In-line battery provides twice the power of the battery built into the Micro System Headset.

When two headsets are connected together using a radio interface, one In-line battery will power both headsets.

When two headsets are connected together using a Headset Coupling Adapter, an In-line Battery is required for both headsets.

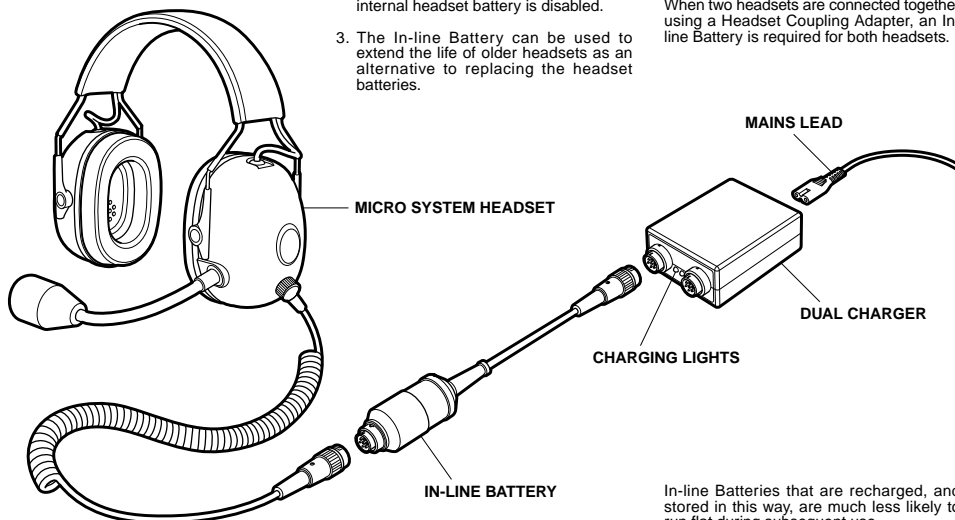

CHARGING:

The Nickel Metal Hydride battery built into the In-line Battery provides for a minimum of fifty hours continuous use when fully charged.

To charge an In-line Battery using the Micro System Charger, plug the In-line Battery into the front of the charger then plug the charger into a wall socket. The charger will accept one or two In-line Batteries and provides a full charge in sixteen hours.

Charging lights are provided on the front of the charger which indicate when a battery is connected and charging. The charging lights only confirm that the charger is working and do not indicate when the In-Line Battery is fully charged.

INITIAL CHARGE:

When charging a new In-Line Battery for the first time, leave the battery on charge for at least twenty four hours. This conditions the battery correctly and prolongs battery life.

OPTIMUM CHARGING:

During normal use, an In-Line Battery will only become partially discharged each day; however, the In-line Battery should be recharged after each use and stored in a fully charged condition.

In-line Batteries that are recharged, and stored in this way, are much less likely to run flat during subsequent use.

The In-line Battery does not suffer from memory effect and it is not necessary to completely discharge the battery before recharging.

The In-Line Battery is designed to accept a full recharge at least one thousand times and, if correctly maintained, will provide many years of reliable service.

WARNING:

The In-Line Battery will self-discharge over a three month period even if it is not used.

Once an In-line Battery has received an initial charge, never store the battery completely discharged as this will damage it.



IMPORTANT

READ THIS INFORMATION CAREFULLY BEFORE
ATTEMPTING TO USE THIS ITEM OF EQUIPMENT